

Central locking rotary lock

- > Area of application: For cylinder cores that are inserted from the front on site
- > Material: Zinc alloy
- > Finish: Nickel plated
- > Version: Lifting pin with 12 or 17 mm travel
- > Closure travel: 180°
- > Cylinder housing length: 22 mm
- > Installation: For installation in fixed front panel

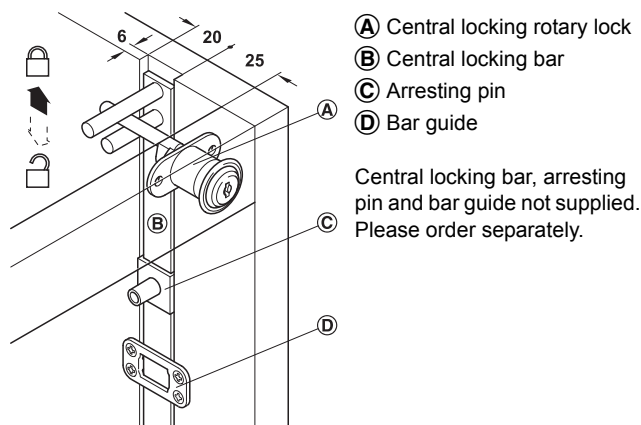

Mount central locking rotary lock on the right hand side.

Order reference

Only use Premium 20 cylinder cores with **restricted rotation and direction (DIN right)** when using pin tumbler cylinder removable cores.

→ With single wing

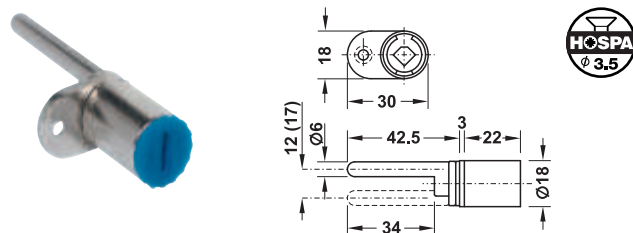

Closure travel	Travel mm	Cat. No.
180°	12	234.98.650
	17	234.98.660

Packing: 1 or 20 pieces

→ With two wings

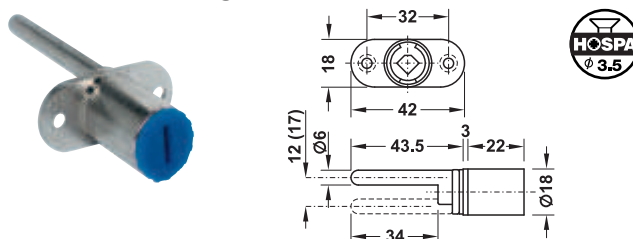

Closure travel	Travel mm	Cat. No.
180°	12	234.98.600
	17	234.98.610

Packing: 1 or 20 pieces

Central locking system

With locking bar

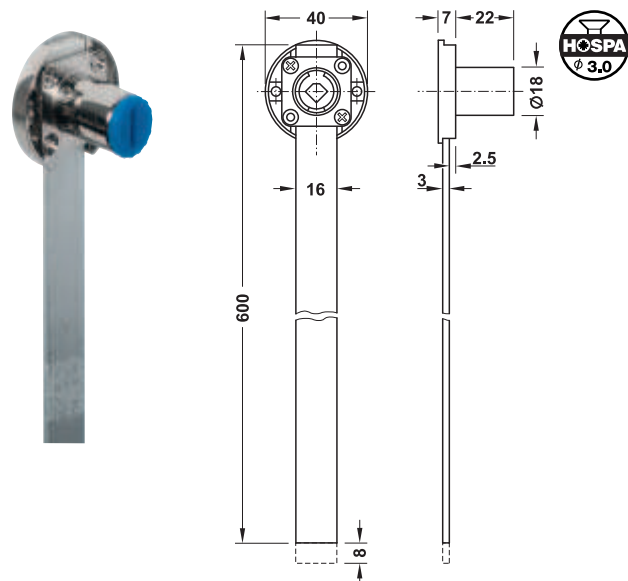

- > Area of application: For cylinder cores that are inserted from the front on site
- > Material: Lock: Zinc alloy, locking bar: Aluminium
- > Finish: Lock: Nickel plated
- > Version: With pre-mounted locking bar
- > Closure travel: 180°
- > Travel: 8 mm
- > Cylinder housing length: 22 mm
- > Installation: For screw fixing

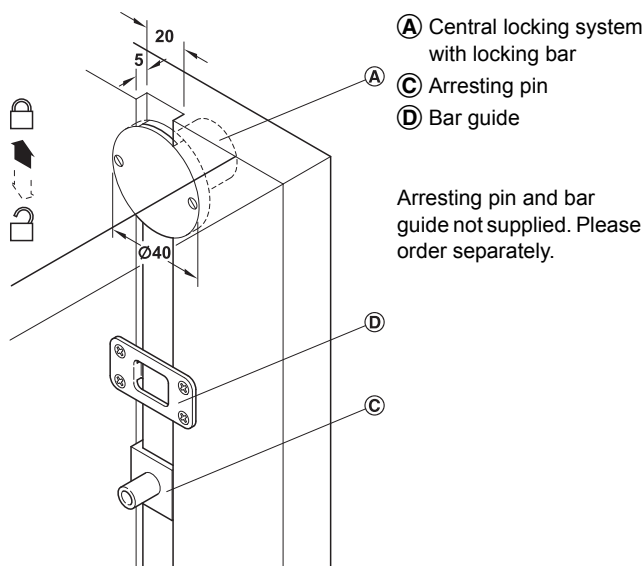

Closure travel	Travel mm	Cat. No.
180°	8	237.48.600

Packing: 1 or 20 pieces

Furniture lock accessories	► MB 6.191
Symo cylinder cores	► MB 6.81
Ⓑ central locking bar	► MB 6.195
Ⓒ arresting pin	► MB 6.195
Ⓓ bar guide	► MB 6.195